



NOTICE OF PLANNED POWER OUTAGES

Two planned power outages will be required in a highly localized area at the south end of Quil Ceda Village as the PUD relocates electrical distribution infrastructure to accommodate street improvements by the Tulalip Tribes. Please see attached maps. Customers impacted by this work will be contacted by PUD either by phone, email, or site visit prior to these planned power outages:

1. The first planned power outage will be **Sunday, April 15, 2018 beginning at 5 a.m. lasting approximately 40 hours until 9 p.m., Monday, April 16, 2018.** This outage is necessary in order to relocate PUD electrical distribution equipment near the intersection of Marine Drive and 31st Ave NE. See page 2 below for impacted area.
2. The second planned power outage will be **Saturday, April 28, 2018 beginning at 5 a.m. lasting approximately 20 hours until 1 a.m., Sunday, April 29, 2018.** This outage is necessary in order to relocate PUD distribution equipment at the intersection of 31st Ave NE and 62nd PI NE. See page 3 below for impacted area.

Prior to the outages, PUD will be working on the two intersections, Marine Dr. & 31st Ave NE and 62nd PI NE & 31st Ave NE, performing preliminary work in preparation for our final construction work. This preparatory work will minimize outage durations.

Please be aware there will be large equipment and materials stored in the Quilceda Creek Casino south parking lot as a staging area for PUD during the time this work is to be in progress. The staging area will be temporary, will further expedite the construction process and is necessary to minimize the outage time experienced by customers in the community.

The PUD appreciates that these two extended outages impact customer business operations. PUD is making every effort to limit the outages durations for this necessary work in this growth area.

For questions please contact Snohomish County PUD:

Kallen Shaughnessy-Randall
Office: 425-783-4370
Cell: 425-245-2836

Sunday, April 15, 2018 beginning at 5 a.m. lasting approximately 40 hours until 9 p.m., Monday, April 16, 2018. Outage will impact customers inside the yellow outline on this map:

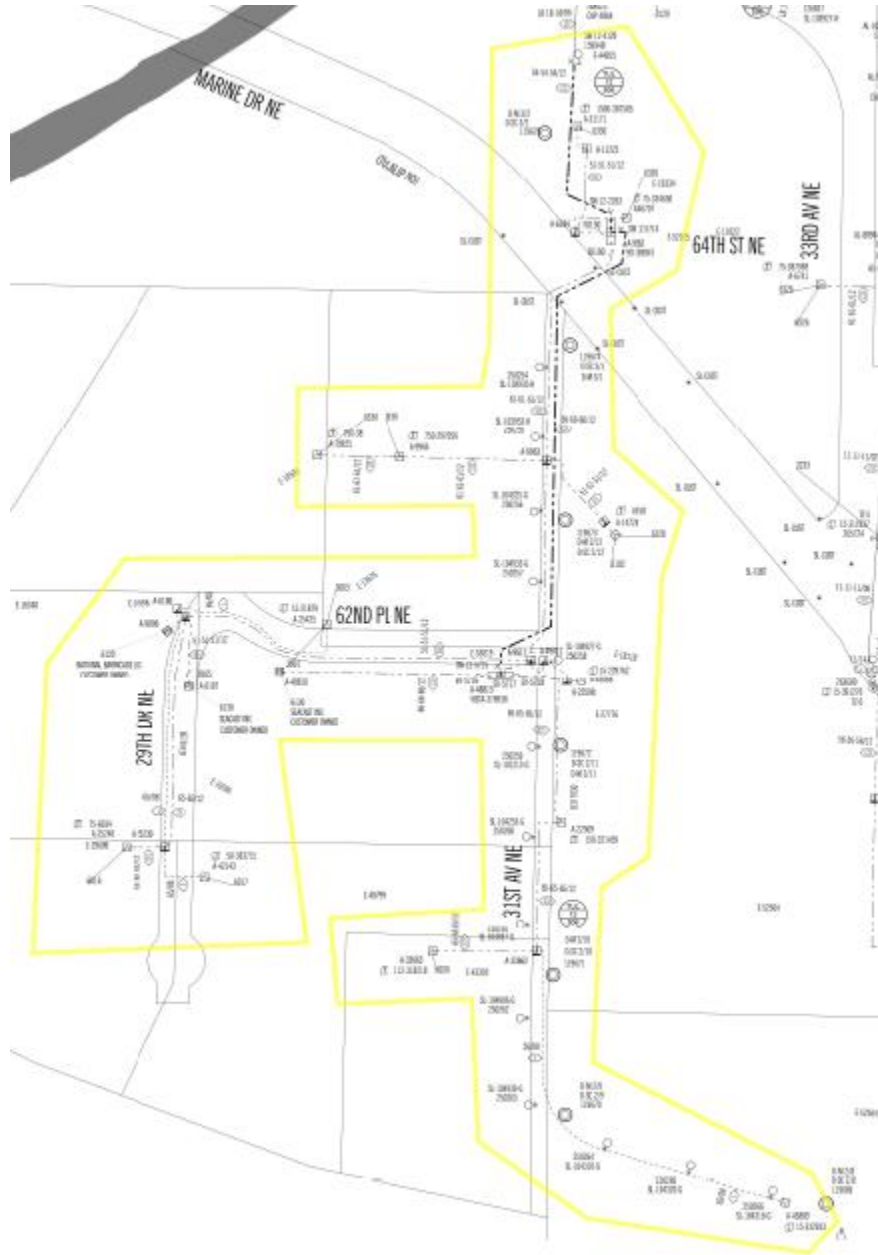

Saturday, April 28, 2018 beginning at 5 a.m. lasting approximately 20 hours until 1 a.m., Sunday, April 29, 2018. Outage will impact customers inside the green outline on this map:

